

## AV-L L 型空氣閥

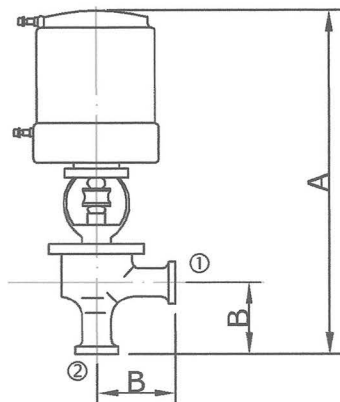

Pneumatic Seat Valve ( SHUT-OFF VALVE ) mm

SIZE	A	B
1 1/2"	352.0	70.3
2"	378.0	89.3
2 1/2"	384.0	89.3
3"	397.0	95.7
N.C.	① open	② close
N.O.	①② open	

## AV-T T 型空氣閥

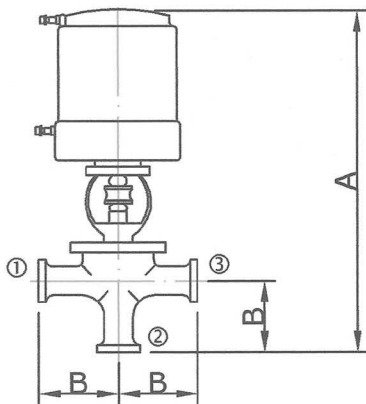

Pneumatic Seat Valve ( SHUT-OFF VALVE ) mm

SIZE	A	B
1 1/2"	352.0	70.3
2"	378.0	89.3
2 1/2"	384.0	89.3
3"	397.0	95.7
N.C.	①③ open	② close
N.O.	①②③ open	

## AV-F F 型空氣閥

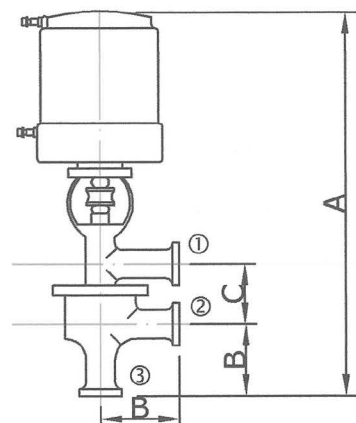

Pneumatic Seat Valve ( DIVERT VALVE ) mm

SIZE	A	B	C
1 1/2"	454.0	70.3	82.5
2"	492.0	89.3	95.3
2 1/2"	511.0	89.3	108.0
3"	537.0	95.7	120.6
N.C.	①② open	③ close	
N.O.	②③ open	① close	

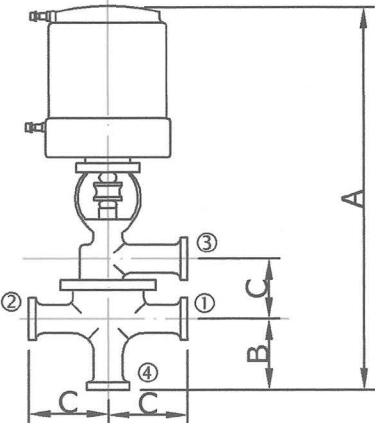
AV-E      E 型空氣閥	Pneumatic Seat Valve ( DIVERT VALVE )      mm			
	SIZE	A	B	C
	1 1/2"	454.0	70.3	82.5
	2"	492.0	89.3	95.3
	2 1/2"	511.0	89.3	108.0
	3"	537.0	95.7	120.6
	N.C.	①②③ open		④ close
	N.O.	①②④ open		③ close

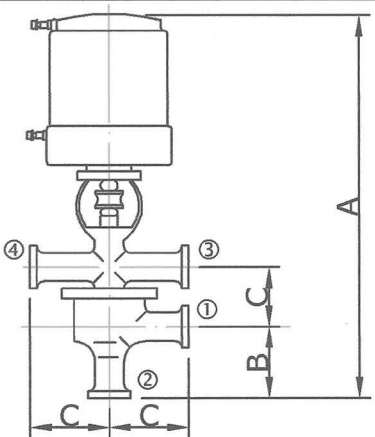
AV-FL      FL 型空氣閥	Pneumatic Seat Valve ( DIVERT VALVE )      mm			
	SIZE	A	B	C
	1 1/2"	454.0	70.3	82.5
	2"	492.0	89.3	95.3
	2 1/2"	511.0	89.3	108.0
	3"	537.0	95.7	120.6
	N.C.	①③④ open		② close
	N.O.	①② open		③④ close

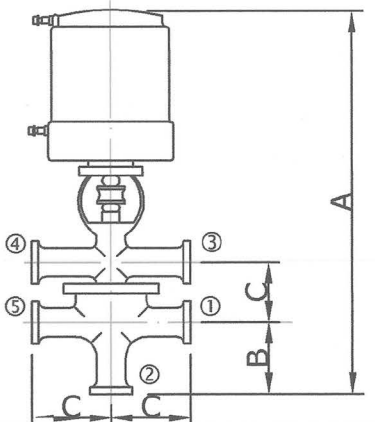
AV-FE      FE 型空氣閥	Pneumatic Seat Valve ( DIVERT VALVE )      mm			
	SIZE	A	B	C
	1 1/2"	454.0	70.3	82.5
	2"	492.0	89.3	95.3
	2 1/2"	511.0	89.3	108.0
	3"	537.0	95.7	120.6
	N.C.	①③④⑤ open		② close
	N.O.	①②⑤ open		③④ close

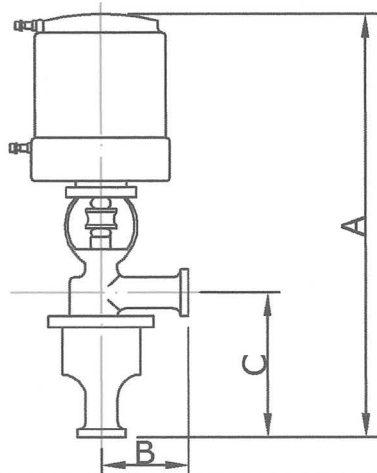
**AV-J****J 型空氣閥**

Pneumatic Seat Valve ( SHUT-OFF VALVE ) mm

SIZE

A

B

C

1 1/2"

454.0

70.3

82.5

2"

492.0

89.3

95.3

2 1/2"

511.0

89.3

108.0

3"

537.0

95.7

120.6

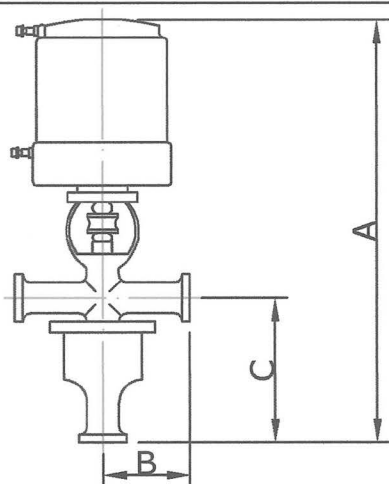
**AV-JT****JT 型空氣閥**

Pneumatic Seat Valve ( SHUT-OFF VALVE ) mm

SIZE

A

B

C

1 1/2"

454.0

70.3

82.5

2"

492.0

89.3

95.3

2 1/2"

511.0

89.3

108.0

3"

537.0

95.7

120.6

# PNEUMATIC SHUT OFF VALVE AV-L

3A Weld / Tri-Clamp / Bevel Seat / IDF / RJT/BSM/ CIP Flat Face / DIN 11851 / SMS 1145 Threaded Male 外牙接口

## 氣動截止閥 / L 閥

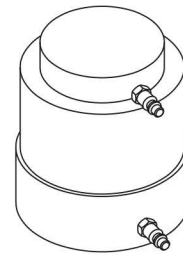
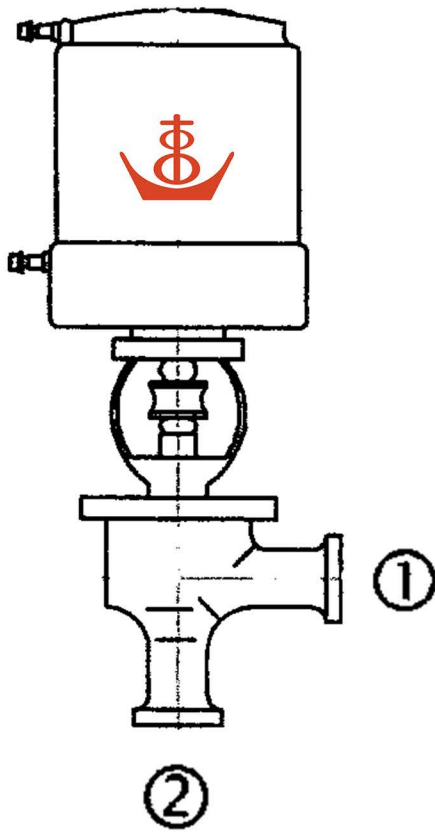

Pneumatic Actuator  
氣動筒 SS304



Actuator Clamp  
氣動筒管束  
13MHMM SS304

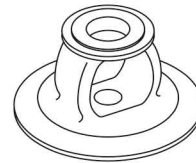

Bonnet, T type  
T接帽 SS316

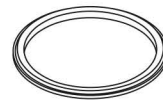

Body Gasket  
AVA矽膠体墊 Silicone



Body Clamp  
閥体管束  
13MHMM SS304

N.C. - Normally close port 2, open port 1.  
Air to all open.

N.O. - Normally all open.  
Air to close port 2, open port 1.

常閉: 接口 2 閉.  
氣動時, 接口 1, 2 通.

常開: 接口 1, 2 通.  
氣動時, 接口 2 閉.

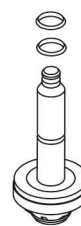

T Stem/Seat Plug Assembly  
T塞桿組

T塞桿組 包含 T Stem(T塞桿) SS316 及  
以下消耗品:

Silicone Oring \*2 (2個 矽膠O環)  
PTFE Snap-On Seat \*1 (1個 TEFLON塞膠)



Lower Body L, 2 ports  
L型雙口体 SS316

### N.C. (Normally Close, Air to Open) 常閉

Pneumatic upward movement, Spring return 氣動時塞桿向上運動, 彈簧作用時塞桿返回

### N.O. (Normally Open, Air to Close) 常開

Pneumatic downward movement, Spring return 氣動時塞桿向下運動, 彈簧作用時塞桿返回

# PNEUMATIC SHUT OFF VALVE AV-T

3A Weld / Tri-Clamp / Bevel Seat / IDF / RJT/BSM/ CIP Flat Face / DIN 11851 / SMS 1145 Threaded Male 外牙接口

## 氣動截止閥 / T 閥

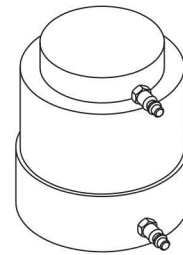
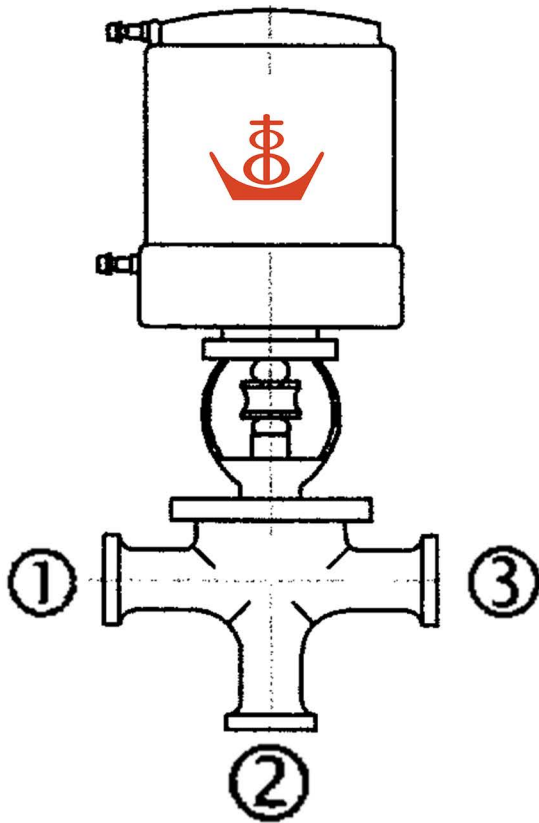

Pneumatic Actuator  
氣動筒 SS304



Actuator Clamp  
氣動筒管束  
13MHMM SS304

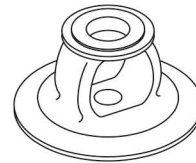

Bonnet, T type  
T接帽 SS316

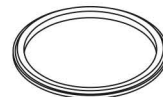

Body Gasket  
AVA矽膠体墊 Silicone



Body Clamp  
閥体管束  
13MHMM SS304

N.C. - Normally close port 2, open port 1, 3.  
Air to all open.

N.O. - Normally all open.  
Air to close port 2.

常閉: 接口 2 閉, 接口 1, 3 通.  
氣動時, 全部接口通.

常開: 全部接口通.  
氣動時, 閉接口 2 .

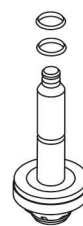

T Stem/Seat Plug Assembly  
T塞桿組

T塞桿組 包含 T Stem(T塞桿) SS316 及  
以下消耗品:

Silicone Oring \*2 (2個 矽膠O環)  
PTFE Snap-On Seat \*1 (1個 TEFLON塞膠)



Lower Body E, 3 ports  
E型三口体 SS316

### N.C. (Normally Close, Air to Open) 常閉

Pneumatic upward movement, Spring return 氣動時塞桿向上運動, 彈簧作用時塞桿返回

### N.O. (Normally Open, Air to Close) 常開

Pneumatic downward movement, Spring return 氣動時塞桿向下運動, 彈簧作用時塞桿返回



# PNEUMATIC DIVERT VALVE AV-F

3A Weld / Tri-Clamp / Bevel Seat / IDF / RJT/BSM/ CIP Flat Face / DIN 11851 / SMS 1145 Threaded Male 外牙接口

## 氣動換向閥 / F 閥

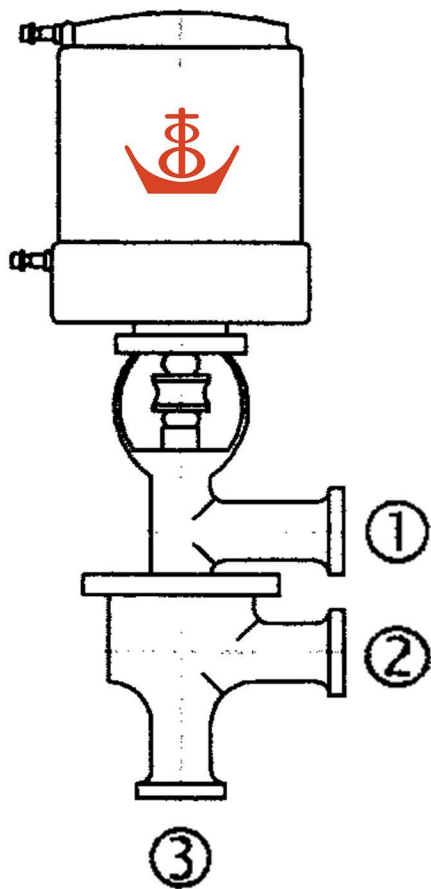

N.C. - Normally close port 3, open port 1, 2.

Air to DIVERT ( close port 1, open port 2, 3 )

N.O. - Normally close port 1, open port 2, 3.

Air to DIVERT ( close port 3, open port 1, 2 )

常閉: 閉接口 3, 通接口 1, 2.

氣動時, 閉接口 1, 通接口 2, 3.

常開: 閉接口 1, 通接口 2, 3.

氣動時, 閉接口 3, 通接口 1, 2.

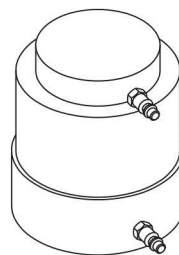

Pneumatic Actuator  
氣動筒 SS304



Actuator Clamp  
氣動筒管束  
13MHHM SS304

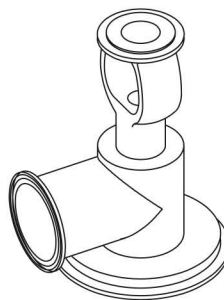

Bonnet, F type  
F接帽 SS316



Body Gasket  
AVA矽膠体墊 Silicone



Body Clamp  
閥体管束  
13MHHM SS304

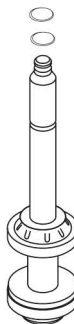

F Stem/Seat Plug Assembly  
F塞桿組

F塞桿組 包含 F Stem(F塞桿) SS316 及  
以下消耗品:

Silicone Oring \*2 (2個 矽膠O環)

PTFE Snap-On Seat \*2 (2個 TEFLON塞膠)



Lower Body L, 2 ports  
L型雙口体 SS316

## N.C. (Normally Close, Air to Open) 常閉

Pneumatic upward movement, Spring return 氣動時塞桿向上運動, 彈簧作用時塞桿返回

## N.O. (Normally Open, Air to Close) 常開

Pneumatic downward movement, Spring return 氣動時塞桿向下運動, 彈簧作用時塞桿返回

# PNEUMATIC DIVERT VALVE AV-E

3A Weld / Tri-Clamp / Bevel Seat / IDF / RJT/BSM/ CIP Flat Face / DIN 11851 / SMS 1145 Threaded Male 外牙接口

## 氣動換向閥 / E 閥

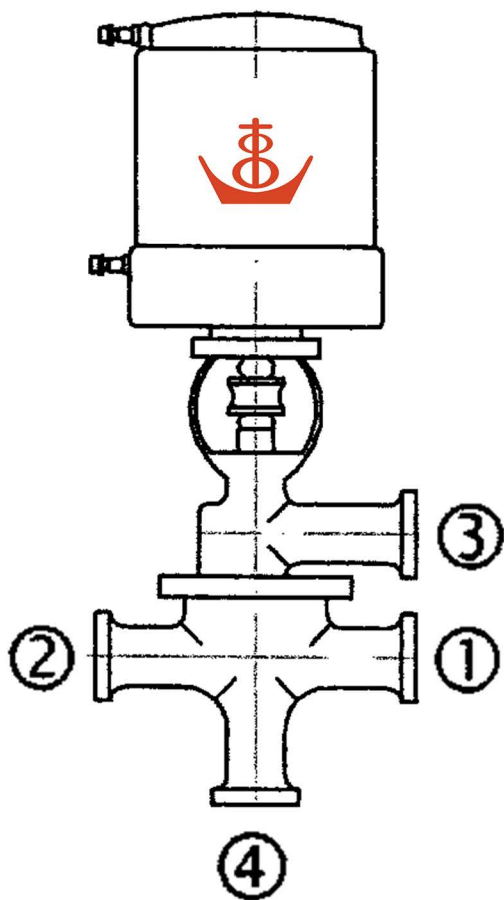

N.C. - Normally close port 4, open port 1, 2, 3.

Air to DIVERT ( close port 3, open port 1, 2, 4 )

N.O. - Normally close port 3, open port 1, 2, 4.

Air to DIVERT ( close port 4, open port 1, 2, 3 )

常閉: 閉接口 4, 通接口 1, 2, 3.

氣動時, 閉接口 3, 通接口 1, 2, 4.

常開: 閉接口 3, 通接口 1, 2, 4.

氣動時, 閉接口 4, 通接口 1, 2, 3.

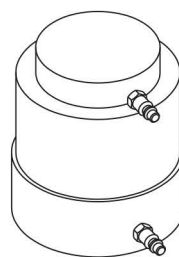

Pneumatic Actuator  
氣動筒 SS304



Actuator Clamp  
氣動筒管束  
13MHHM SS304

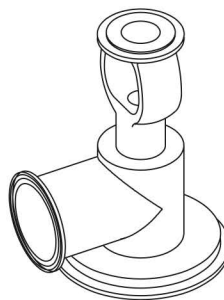

Bonnet, F type  
F接帽 SS316

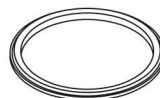

Body Gasket  
AVA矽膠体墊 Silicone



Body Clamp  
閥体管束  
13MHHM SS304

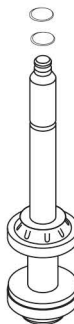

F Stem/Seat Plug Assembly  
F塞桿組

F塞桿組 包含 F Stem(F塞桿) SS316 及  
以下消耗品:

Silicone Oring \*2 (2個 矽膠O環)

PTFE Snap-On Seat \*2 (2個 TEFLON塞膠)



Lower Body E, 3 ports  
E型三口体 SS316

## N.C. (Normally Close, Air to Open) 常閉

Pneumatic upward movement, Spring return 氣動時塞桿向上運動, 彈簧作用時塞桿返回

## N.O. (Normally Open, Air to Close) 常開

Pneumatic downward movement, Spring return 氣動時塞桿向下運動, 彈簧作用時塞桿返回