

AV-L L 型空氣閥

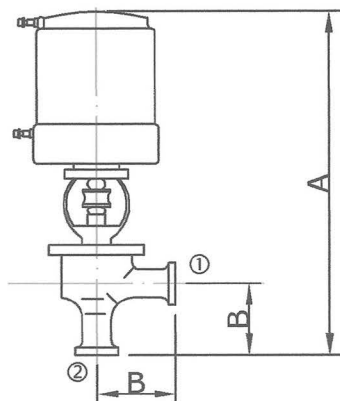

Pneumatic Seat Valve (SHUT-OFF VALVE) mm

SIZE	A	B
1 1/2"	352.0	70.3
2"	378.0	89.3
2 1/2"	384.0	89.3
3"	397.0	95.7
N.C.	① open	② close
N.O.	①② open	

AV-T T 型空氣閥

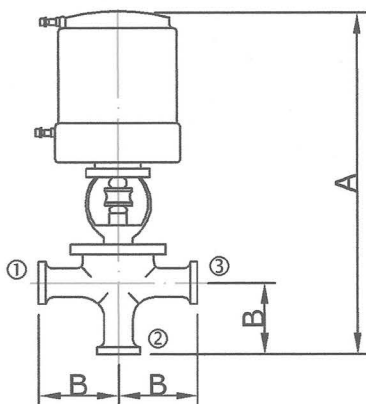

Pneumatic Seat Valve (SHUT-OFF VALVE) mm

SIZE	A	B
1 1/2"	352.0	70.3
2"	378.0	89.3
2 1/2"	384.0	89.3
3"	397.0	95.7
N.C.	①③ open	② close
N.O.	①②③ open	

AV-F F 型空氣閥

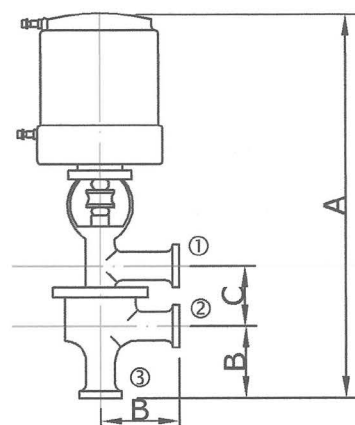

Pneumatic Seat Valve (DIVERT VALVE) mm

SIZE	A	B	C
1 1/2"	454.0	70.3	82.5
2"	492.0	89.3	95.3
2 1/2"	511.0	89.3	108.0
3"	537.0	95.7	120.6
N.C.	①② open	③ close	
N.O.	②③ open	① close	

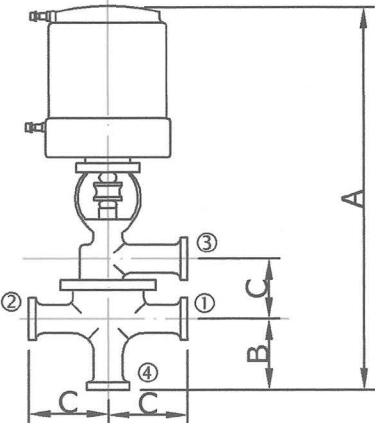
AV-E E 型空氣閥	Pneumatic Seat Valve (DIVERT VALVE) mm			
	SIZE	A	B	C
	1 1/2"	454.0	70.3	82.5
	2"	492.0	89.3	95.3
	2 1/2"	511.0	89.3	108.0
	3"	537.0	95.7	120.6
	N.C.	①②③ open		④ close
	N.O.	①②④ open		③ close

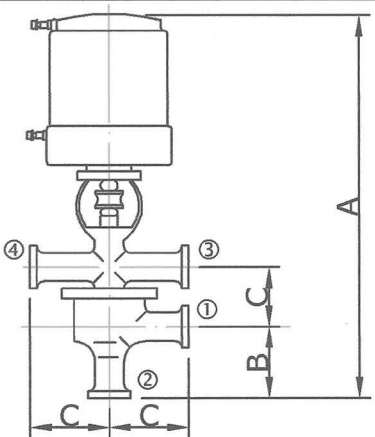
AV-FL FL 型空氣閥	Pneumatic Seat Valve (DIVERT VALVE) mm			
	SIZE	A	B	C
	1 1/2"	454.0	70.3	82.5
	2"	492.0	89.3	95.3
	2 1/2"	511.0	89.3	108.0
	3"	537.0	95.7	120.6
	N.C.	①③④ open		② close
	N.O.	①② open		③④ close

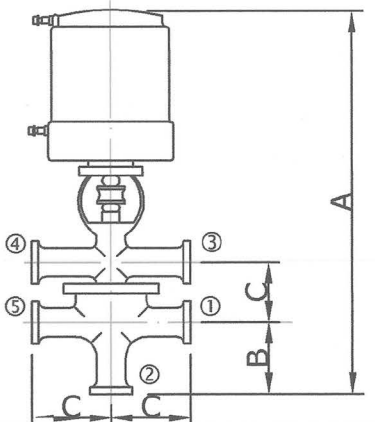
AV-FE FE 型空氣閥	Pneumatic Seat Valve (DIVERT VALVE) mm			
	SIZE	A	B	C
	1 1/2"	454.0	70.3	82.5
	2"	492.0	89.3	95.3
	2 1/2"	511.0	89.3	108.0
	3"	537.0	95.7	120.6
	N.C.	①③④⑤ open		② close
	N.O.	①②⑤ open		③④ close

AV-J**J 型空氣閥**

Pneumatic Seat Valve (SHUT-OFF VALVE) mm

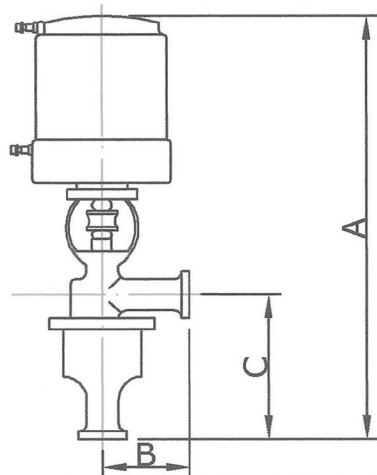

SIZE

A

B

C

1 1/2"

454.0

70.3

82.5

2"

492.0

89.3

95.3

2 1/2"

511.0

89.3

108.0

3"

537.0

95.7

120.6

AV-JT**JT 型空氣閥**

Pneumatic Seat Valve (SHUT-OFF VALVE) mm

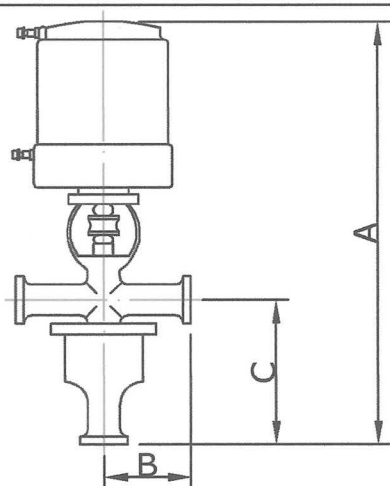

SIZE

A

B

C

1 1/2"

454.0

70.3

82.5

2"

492.0

89.3

95.3

2 1/2"

511.0

89.3

108.0

3"

537.0

95.7

120.6

PNEUMATIC SHUT OFF VALVE AV-L

3A Weld / Tri-Clamp / Bevel Seat / IDF / RJT/BSM/ CIP Flat Face / DIN 11851 / SMS 1145 Threaded Male 外牙接口

氣動截止閥 / L 閥

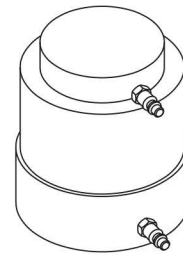
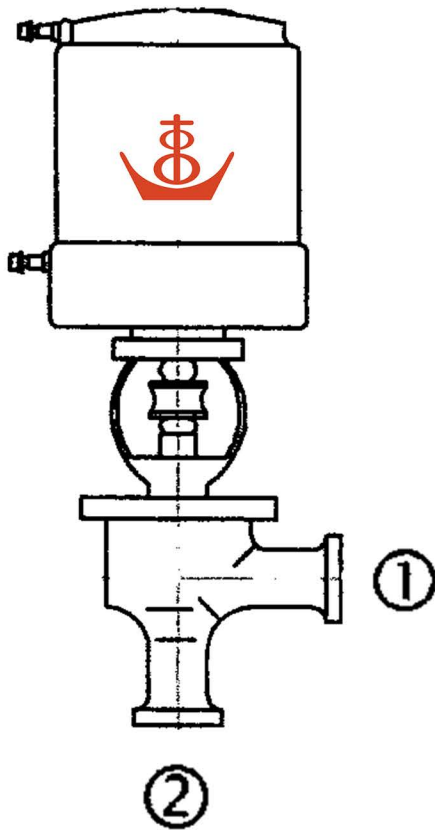

Pneumatic Actuator
氣動筒 SS304



Actuator Clamp
氣動筒管束
13MHMM SS304

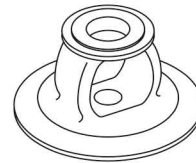

Bonnet, T type
T接帽 SS316



Body Gasket
AVA矽膠体墊 Silicone



Body Clamp
閥体管束
13MHMM SS304

N.C. - Normally close port 2, open port 1.
Air to all open.

N.O. - Normally all open.
Air to close port 2, open port 1.

常閉: 接口 2 閉.
氣動時, 接口 1, 2 通.

常開: 接口 1, 2 通.
氣動時, 接口 2 閉.

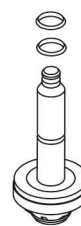

T Stem/Seat Plug Assembly
T塞桿組

T塞桿組 包含 T Stem(T塞桿) SS316 及
以下消耗品:

Silicone Oring *2 (2個 矽膠O環)
PTFE Snap-On Seat *1 (1個 TEFLON塞膠)



Lower Body L, 2 ports
L型雙口体 SS316

N.C. (Normally Close, Air to Open) 常閉

Pneumatic upward movement, Spring return 氣動時塞桿向上運動, 彈簧作用時塞桿返回

N.O. (Normally Open, Air to Close) 常開

Pneumatic downward movement, Spring return 氣動時塞桿向下運動, 彈簧作用時塞桿返回

PNEUMATIC SHUT OFF VALVE AV-T

3A Weld / Tri-Clamp / Bevel Seat / IDF / RJT/BSM/ CIP Flat Face / DIN 11851 / SMS 1145 Threaded Male 外牙接口

氣動截止閥 / T 閥

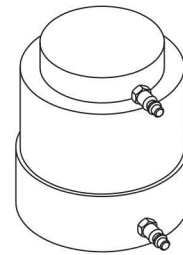
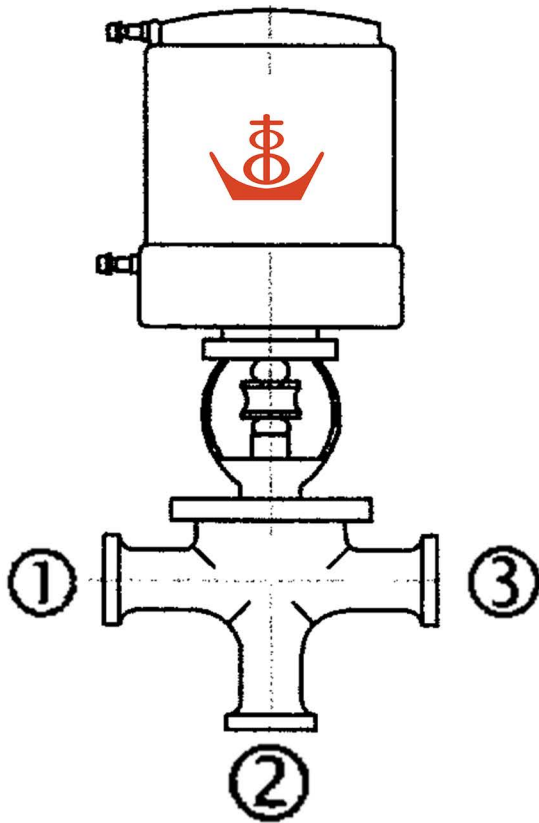

Pneumatic Actuator
氣動筒 SS304



Actuator Clamp
氣動筒管束
13MHM SS304

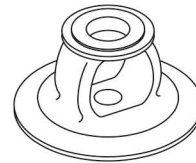

Bonnet, T type
T接帽 SS316

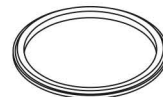

Body Gasket
AVA矽膠体墊 Silicone



Body Clamp
閥体管束
13MHM SS304

N.C. - Normally close port 2, open port 1, 3.
Air to all open.

N.O. - Normally all open.
Air to close port 2.

常閉: 接口 2 閉, 接口 1, 3 通.
氣動時, 全部接口通.

常開: 全部接口通.
氣動時, 閉接口 2 .

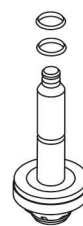

T Stem/Seat Plug Assembly
T塞桿組

T塞桿組 包含 T Stem(T塞桿) SS316 及
以下消耗品:

Silicone Oring *2 (2個 矽膠O環)
PTFE Snap-On Seat *1 (1個 TEFLON塞膠)



Lower Body E, 3 ports
E型三口体 SS316

N.C. (Normally Close, Air to Open) 常閉

Pneumatic upward movement, Spring return 氣動時塞桿向上運動, 彈簧作用時塞桿返回

N.O. (Normally Open, Air to Close) 常開

Pneumatic downward movement, Spring return 氣動時塞桿向下運動, 彈簧作用時塞桿返回

PNEUMATIC DIVERT VALVE AV-F

3A Weld / Tri-Clamp / Bevel Seat / IDF / RJT/BSM/ CIP Flat Face / DIN 11851 / SMS 1145 Threaded Male 外牙接口

氣動換向閥 / F 閥

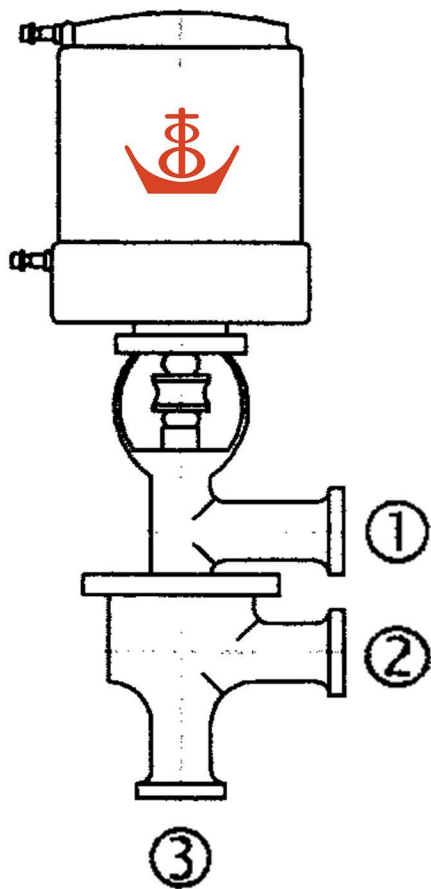

N.C. - Normally close port 3, open port 1, 2.

Air to DIVERT (close port 1, open port 2, 3)

N.O. - Normally close port 1, open port 2, 3.

Air to DIVERT (close port 3, open port 1, 2)

常閉: 閉接口 3, 通接口 1, 2.

氣動時, 閉接口 1, 通接口 2, 3.

常開: 閉接口 1, 通接口 2, 3.

氣動時, 閉接口 3, 通接口 1, 2.

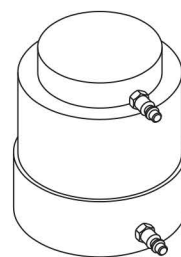

Pneumatic Actuator
氣動筒 SS304



Actuator Clamp
氣動筒管束
13MHHM SS304

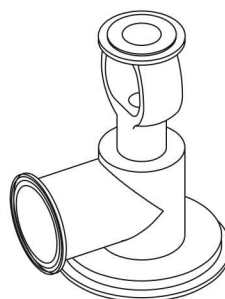

Bonnet, F type
F接帽 SS316

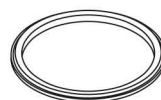

Body Gasket
AVA矽膠体墊 Silicone



Body Clamp
閥体管束
13MHHM SS304

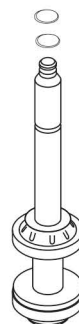

F Stem/Seat Plug Assembly
F塞桿組

F塞桿組 包含 F Stem(F塞桿) SS316 及
以下消耗品:

Silicone Oring *2 (2個 矽膠O環)

PTFE Snap-On Seat *2 (2個 TEFLON塞膠)



Lower Body L, 2 ports
L型雙口体 SS316

N.C. (Normally Close, Air to Open) 常閉

Pneumatic upward movement, Spring return 氣動時塞桿向上運動, 彈簧作用時塞桿返回

N.O. (Normally Open, Air to Close) 常開

Pneumatic downward movement, Spring return 氣動時塞桿向下運動, 彈簧作用時塞桿返回

PNEUMATIC DIVERT VALVE AV-E

3A Weld / Tri-Clamp / Bevel Seat / IDF / RJT/BSM/ CIP Flat Face / DIN 11851 / SMS 1145 Threaded Male 外牙接口

氣動換向閥 / E 閥

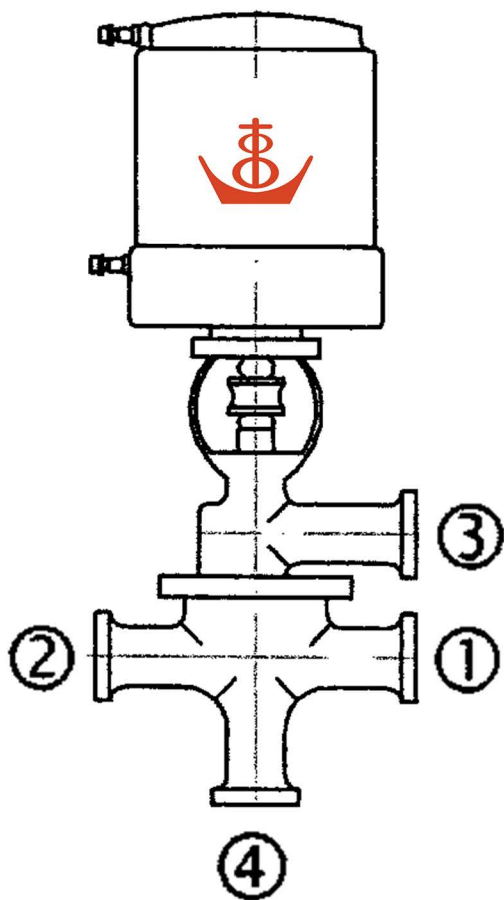

N.C. - Normally close port 4, open port 1, 2, 3.

Air to DIVERT (close port 3, open port 1, 2, 4)

N.O. - Normally close port 3, open port 1, 2, 4.

Air to DIVERT (close port 4, open port 1, 2, 3)

常閉: 閉接口 4, 通接口 1, 2, 3.

氣動時, 閉接口 3, 通接口 1, 2, 4.

常開: 閉接口 3, 通接口 1, 2, 4.

氣動時, 閉接口 4, 通接口 1, 2, 3.

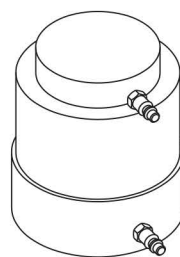

Pneumatic Actuator
氣動筒 SS304



Actuator Clamp
氣動筒管束
13MHHM SS304

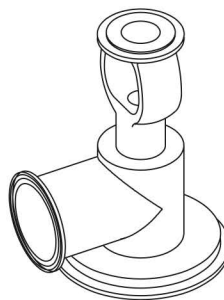

Bonnet, F type
F接帽 SS316



Body Gasket
AVA矽膠体墊 Silicone



Body Clamp
閥体管束
13MHHM SS304

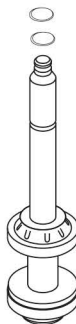

F Stem/Seat Plug Assembly
F塞桿組

F塞桿組 包含 F Stem(F塞桿) SS316 及
以下消耗品:

Silicone Oring *2 (2個 矽膠O環)

PTFE Snap-On Seat *2 (2個 TEFLON塞膠)



Lower Body E, 3 ports
E型三口体 SS316

N.C. (Normally Close, Air to Open) 常閉

Pneumatic upward movement, Spring return 氣動時塞桿向上運動, 彈簧作用時塞桿返回

N.O. (Normally Open, Air to Close) 常開

Pneumatic downward movement, Spring return 氣動時塞桿向下運動, 彈簧作用時塞桿返回

玄盛企業股份有限公司
 食品衛生級 不鏽鋼管及管件
 外徑及厚度比較表
 " Outer Diameter & Wall Thickness of the Hygienic Tubings "
 - TECH CONTROL ENTERPRISE CO., LTD.

3A			IDF			RJT/ BSM/ CIP Flat Face			DIN 11851			SMS		
尺寸 SIZE	外徑 OD (mm)	厚度 T (mm)	尺寸 SIZE	外徑 OD (mm)	厚度 T (mm)	尺寸 SIZE	外徑 OD (mm)	厚度 T (mm)	尺寸 SIZE	外徑 OD (mm)	厚度 T (mm)	尺寸 SIZE	外徑 OD (mm)	厚度 T (mm)
1/2"	12.7	1.65							10	15.0	2.5			
3/4"	19.05	1.65							15	21.0	2.5			
1"	25.4	1.65	1"	25.4	1.2	1"	25.8	1.8	20	25.0	2.5	1"	25.0	1.25
1.25"	31.75	1.65							25	31.0	2.5			
1.5"	38.1	1.65	1.5"	38.1	1.2	1.5"	38.5	1.8	32	37.0	2.5	1.5"	38.0	1.25
									40	43.0	2.5			
2"	50.8	1.65	2"	50.8	1.5	2"	51.2	1.8	50	55.0	2.5	2"	51.0	1.25
2.5"	63.5	1.65	2.5"	63.5	2.0	2.5"	63.9	1.8	65	72.0	3.0	2.5"	63.5	1.5
3"	76.2	1.65	3"	76.2	2.0	3"	76.6	1.8				3"	76.1	1.6
			3.5"	89.1	2.0				80	87.0	3.0			
4"	101.6	2.1	4"	101.6	2.0	4"	102.0	2.2	100	106.0	3.0	4" / 4"EB	101.6 / 104	2.0 / 2.0
			4.5"	114.3	3.0									
									125	132.0	3.5			
6"	152.4	2.8				6"	152.8	2.2	150	157.0	3.5			
8"	203.2	2.8												
10"	254.0	3.47												
12"	304.8	3.47												

表面處理參考表

Surface Finish Cross Reference		
Grit No.	Ra (µin.)	Ra (µm)
120		
180	32	0.8
240	25	0.6
320	20	0.5

玄盛企業股份有限公司 食品衛生級 墊片材料特性 比較表

" Gasket Material Selection Guide / Gasket Material Characteristics Comparison Chart " - TECH CONTROL ENTERPRISE CO., LTD.

墊片材料特性 Gasket Material Characteristics	SILICONE	EPDM	VITON (FKM)	TEFLON (PTFE)	BUNA-N
建議操作溫度 Recommend Operating Temperature	-30°C~120°C	-30°C~100°C	-15°C~120°C	-30°C~160°C	-10°C~100°C
耐酸鹼度 Acid/Alkali Resistance	一般 Fair	一般 Fair	良 Good	優 Excellent	一般 Fair
耐臭氧度 Ozone Resistance	一般 Fair	優 Excellent	一般 Fair	一般 Fair	差 Poor
顏色 Color	白色半透明 Translucent White	黑 Black	黑 Black	白 White	原色為淺褐色, 可訂製為白色 Original color is light brown, customizable to white
其它備註事項 Other Comments	耐高溫 heat resistant	耐臭氧 Ozone resistance	耐酒精 alcohol resistance	耐酸鹼及溶劑 acid, alkali, and solvent resistant, 硬 hard	耐油 oil resistance



玄盛企業股份有限公司

專業製造 食品衛生級 不鏽鋼管、管件、閥、泵浦
CNC金屬加工、產業機械設備金屬零件代工製造



dun & bradstreet
D-U-N-S® CERTIFIED
65-736-5078

www.tech-control-tw.com

TECH CONTROL ENTERPRISE CO., LTD.

techcontrol@seed.net.tw

●不鏽鋼 食品衛生級 夾接管件、對焊管件、擴管管件 3A、IDF、RJT/BSM/CIP Flat Face、DIN 11851、SMS
Tri-Clamp / Bevel Seat / Butt Weld / Roll-On Expanding HYGIENIC TUBE FITTINGS



Tri-Clamp接頭/夾盤(Ferrule)、盲蓋(Blank)
管夾/夾帶/卡箍(Clamp)、軟管接頭(Hose Barb)
45°、90° 彎頭(Elbow)、大小頭(Reducer)
三通(Tee)、平口三通、十字通(Cross)
管架/管束(Support & Hanger)、食品級墊片
Silicone、EPDM、Viton、Teflon、Buna-N

Strainer & Filter 過濾器

Sight Glass 玻璃視窗

Sight Liquid Level Gauge 液位計

Sampling Valve 取樣閥

CIP Cleaning Spray Ball CIP清洗球

Rotary Spray Ball 旋轉噴球



●不鏽鋼 食品衛生級 手動/氣動 各式閥件 Manual / Pneumatic HYGIENIC VALVES

蝶閥(Butterfly Valve)、考克閥(Plug Valve)、逆止閥(Check Valve)、球閥(Ball Valve)、座閥(Seat Valve)

換向閥(Divert Valve)、截止閥(Shut-Off Valve)、隔膜閥(Diaphragm Valve)、桶底閥(Tank Flush Valve)

接口: 3A Tri-Clamp夾式(Ferrule Ends)、焊式(Weld Ends)、IDF、RJT/BSM/CIP Flat Face、DIN 11851、SMS

尺寸: 1"、1.5"、2"、2.5"、3"、4"

耐壓: 水壓 10 kg/cm² (142 psi at 30° C / 86° F)



●不鏽鋼 食品衛生級 離心式泵浦 CIP HYGIENIC CENTRIFUGAL PUMPS ●不鏽鋼管 HYGIENIC TUBES ASTM A270

●產業機械設備金屬零件代工製造 OEM / CUSTOM METAL PARTS for Machinery & Equipment



22055 新北市 板橋區 倉後街 24 號 1 樓 No.24, Tsang Hou St., BanQiao Dist., New Taipei City 22055, TAIWAN
TEL: (02) 2968-5577 / 2967-5553 FAX: (02) 2967-5545 / 2968-9740

統一編號: 22780634

TECH CONTROL ENTERPRISE CO., LTD.
is a Member of TAITRA